

**REGISTERED SURVEYOR'S CERTIFICATION**  
 TILLERMAN - STAGE 2  
 Saunders Havill Group Pty Ltd, Registered Surveyor, hereby certify that the vertical and horizontal locations and dimensions shown on this plan are a true and correct record and were located by survey.  
 \_\_\_\_\_  
 Authorised Signatory      Reg. Surveyor No. 4611      Date: Preliminary

**ADAC Verification Plot**

Project Name: Tillerman - Stage 2	ADAC version: 5.0.1
Description: Subdivision	Horizontal coordinates: MGA56 (MGA94)
Works Approval ID: OW/223/2022	Vertical datum: AHD
Receiver: Logan City Council	Notes: Vertical Origin: PM70079, RL 57.043 AHD
Construction date: 2024-01-07	Surveyor: Saunders Havill Group (Reg ID 4611)
Status: As Constructed	Engineer: Colliers Engineering & Design

Note: See ADAC xml file for full attribute information

All house connections are  $\phi$ 100 unless otherwise noted.

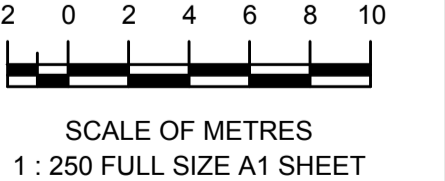

SEE SHEET 2

**A1**

REV NO	DATE	REVISION PURPOSE / DESCRIPTION	DRAWN	RPEQ	RPEQ No
A	23.11.23	Original Issue			

DRAWN	PS	13/09/2023
CHECKED	-	-
APPROVED		
INITIALS		DATE

**saunders havill group**  
 Saunders Havill Group Pty Ltd ABN 24 644 972 949  
 head office 9 Thompson St Bowen Hills Q 4006  
 phone 1800 823 5143 web www.saundershavill.com  
 ■ surveying ■ town planning ■ urban design ■ environmental management ■ landscape architecture

**Colliers INTERNATIONAL**

**TILLERMAN PARK RIDGE**

**TILLERMAN - STAGE 2**  
**PARK RIDGE ROAD, PARK RIDGE**  
**PLAN OF ADAC SURVEY DATA**  
**SEWERAGE RETICULATION OW/223/2022**

<b>DRAWING STATUS</b>	
<b>AS CONSTRUCTED</b>	
SHEET 1 OF 3 SHEETS	
DRAWING NO.	REV.
10652 S 26 AC A	A

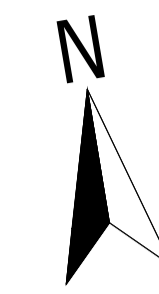

SEE SHEET 1

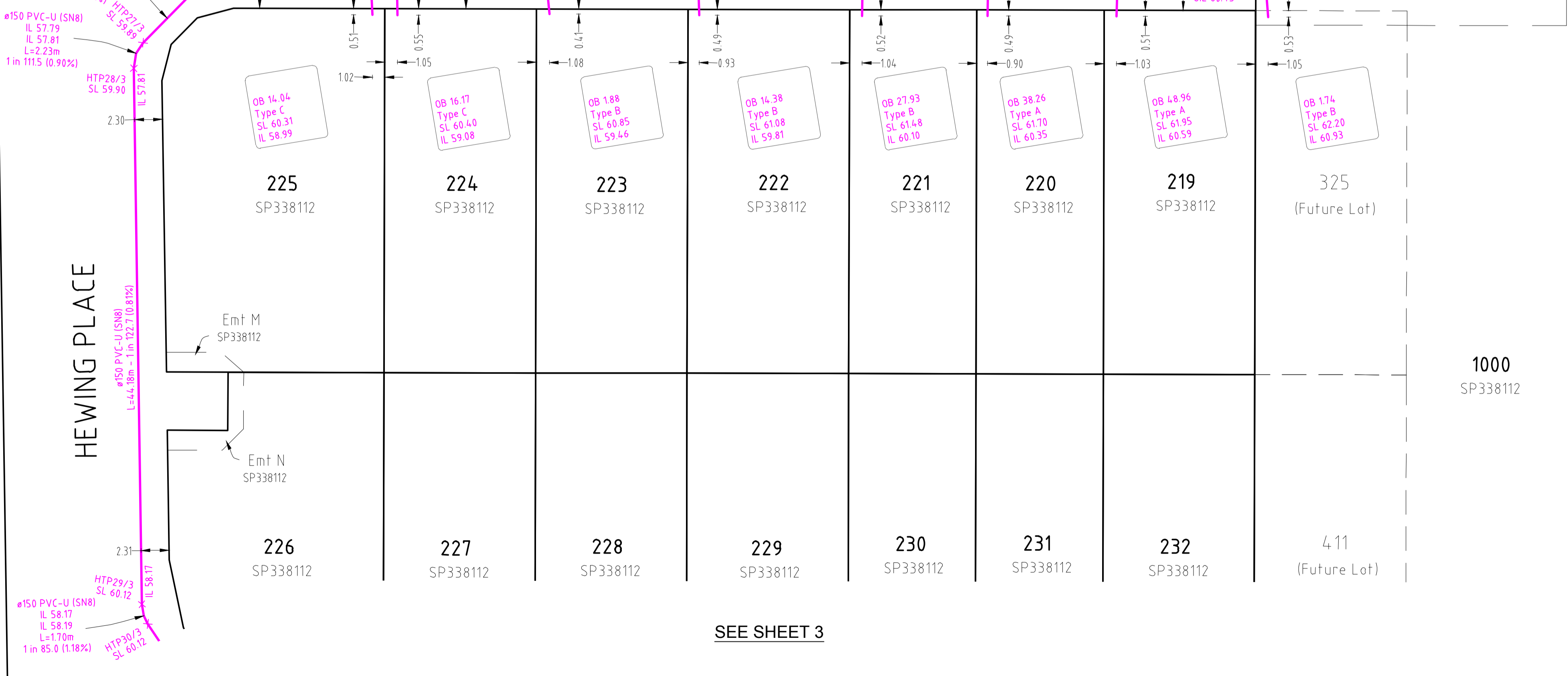
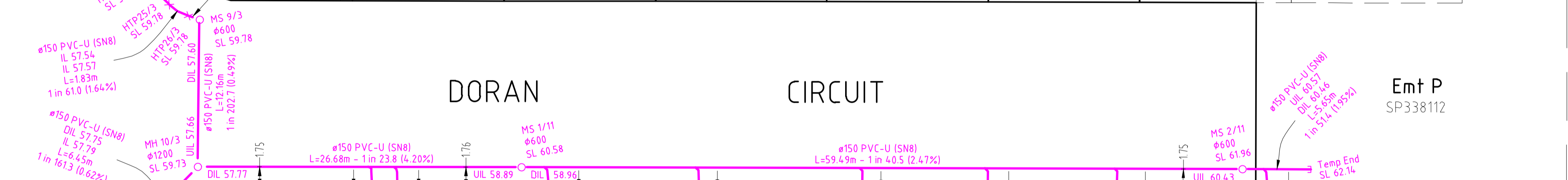
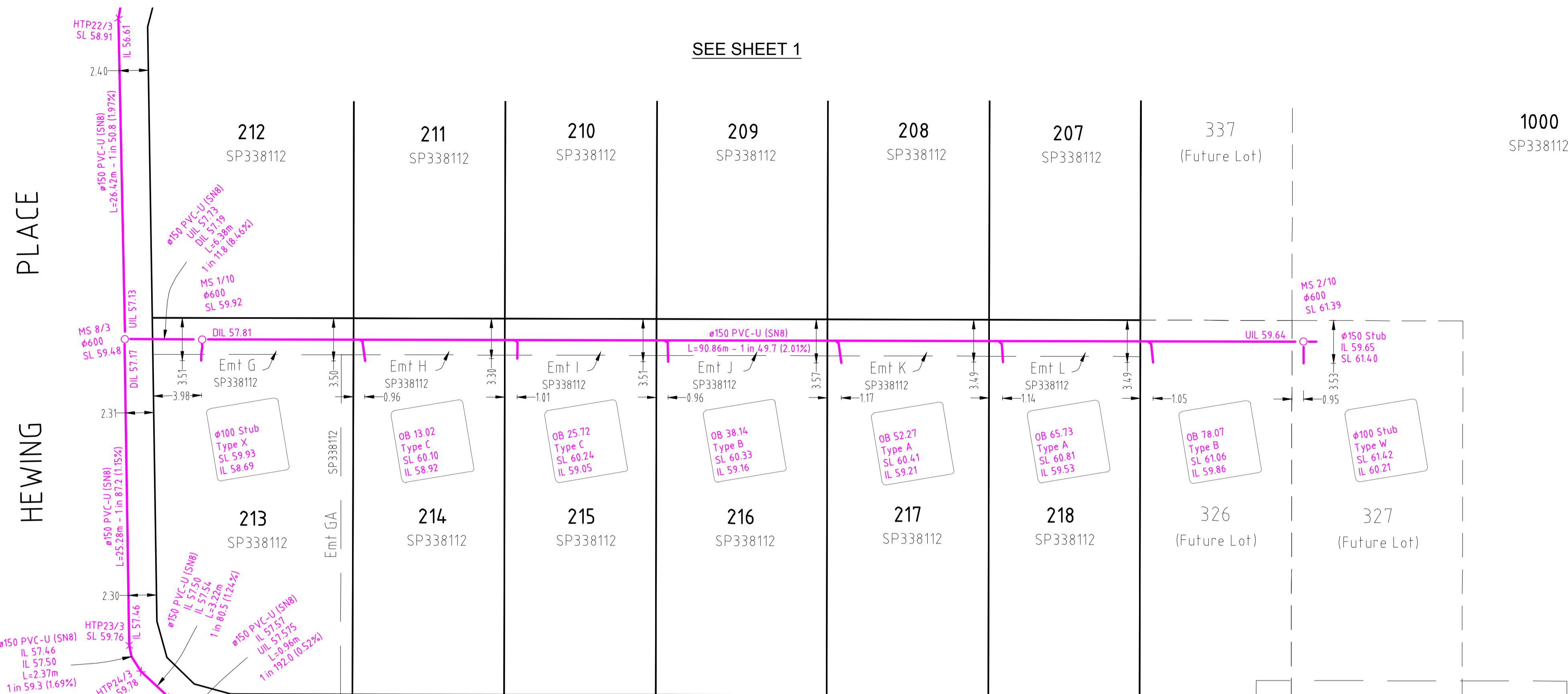

SEE SHEET 3

**REGISTERED SURVEYOR'S CERTIFICATION**  
 TILLERMAN - STAGE 2  
 Saunders Havill Group Pty Ltd, Registered Surveyor, hereby certify that the vertical and horizontal locations and dimensions shown on this plan are a true and correct record and were located by survey.  
 \_\_\_\_\_  
 Authorised Signatory      Reg. Surveyor No. 4611      Date: Preliminary

**ADAC Verification Plot**  
 Project Name: Tillerman - Stage 2  
 Description: Subdivision  
 Works Approval ID: OW/223/2022  
 Receiver: Logan City Council  
 Construction date: 2024-01-07  
 Status: As Constructed  
 ADAC version: 5.0.1  
 Horizontal coordinates: MGA56 (MGA94)  
 Vertical datum: AHD  
 Notes: Vertical Origin: PM70079, RL 57.043 AHD  
 Surveyor: Saunders Havill Group (Reg ID 4611)  
 Engineer: Colliers Engineering & Design  
 Note: See ADAC xml file for full attribute information

All house connections are #100 unless otherwise noted.

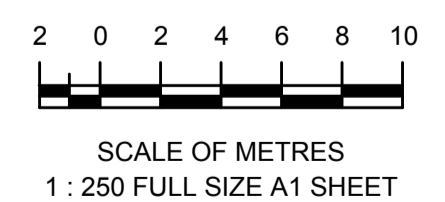

2  
RP137533

<b>A1</b>	REV NO	DATE	REVISION PURPOSE / DESCRIPTION	DRAWN	RPEQ	RPEQ No	INITIALS	DATE
	A	23.11.23	Original Issue					

DRAWN	PS	13/09/2023
CHECKED	-	-
APPROVED		

**TILLERMAN - STAGE 2**  
**PARK RIDGE ROAD, PARK RIDGE**  
**PLAN OF ADAC SURVEY DATA**  
**SEWERAGE RETICULATION OW/223/2022**

<b>DRAWING STATUS</b> <b>AS CONSTRUCTED</b>	
SHEET 2 OF 3 SHEETS	
DRAWING NO. 10652 S 26 AC A	REV. A

saunders havill group  
 Saunders Havill Group Pty Ltd ABN 54 644 972 949  
 head office 9 Thompson St Bowen Hills Q 4006  
 phone 1800 823 5HG web www.saundershavill.com  
 #surveying #townplanning #urban design #environmental management #landscape architecture  
 Drawing No: 10652 S 26 AC A



SEE SHEET 2

HEWING PLACE



**REGISTERED SURVEYOR'S CERTIFICATION**  
 TILLERMAN - STAGE 2

Saunders Havill Group Pty Ltd, Registered Surveyor, hereby certify that the vertical and horizontal locations and dimensions shown on this plan are a true and correct record and were located by survey.

*James Collier*  
 Authorised Signatory      Reg. Surveyor No. 4611      Date: Preliminary

ADAC Verification Plot

Project Name: Tillerman - Stage 2      ADAC version: 5.01  
 Description: Subdivision      Horizontal coordinates: MGA56 (MGA94)  
 Works Approval ID: OW/223/2022      Vertical datum: AHD  
 Receiver: Logan City Council      Notes: Vertical Origin: PM70079, RL 57.043 AHD  
 Construction date: 2024-01-07      Surveyor: Saunders Havill Group (Reg ID 4611)  
 Status: As Constructed      Engineer: Colliers Engineering & Design

Note: See ADAC xml file for full attribute information

All house connections are  $\phi$ 100 unless otherwise noted.

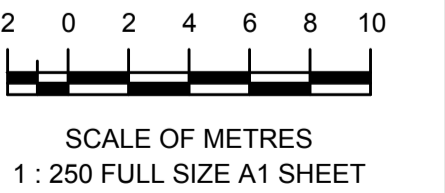

A1

REV NO	DATE	REVISION PURPOSE / DESCRIPTION	DRAWN	RPEQ	RPEQ No	INITIALS	DATE
A	23.11.23	Original Issue					

DRAWN PS 13/09/2023

CHECKED - -

APPROVED

saunders havill group  
 Saunders Havill Group Pty Ltd ABN 04 644 970 949  
 head office 9 Thompson St Bowen Hills Q 4006  
 phone 1800 823 SHG web www.saundershavill.com  
 ■ surveying ■ town planning ■ urban design ■ environmental management ■ landscape architecture

Colliers INTERNATIONAL

TILLERMAN PARK RIDGE

Drawing No: 10652 S 26 AC A

TILLERMAN - STAGE 2  
 PARK RIDGE ROAD, PARK RIDGE

PLAN OF ADAC SURVEY DATA  
 SEWERAGE RETICULATION OW/223/2022

DRAWING STATUS <b>AS CONSTRUCTED</b>	
SHEET 3 OF 3 SHEETS	
DRAWING NO. 10652 S 26 AC A	REV. A



**SCHEDULE OF FITTINGS**

①	Ø150 11.25° Bend
②	Ø150 22.5° Bend
③	Ø150 45° Bend
④	Ø150 90° Bend
⑤	Ø150 Dead End Cap
⑥	Ø150 Hydrant
⑦	Ø150 Valve
⑧	Ø150 x Ø150 Tee

**WATER FITTINGS LEGEND**

	Hydrant
	Valve
	Bend
	Water Fitting
	Dead End Cap
	Reducer
	Water Meter
	Conduit Crossing and Service Pipe

Note: See ADAC xml file for full attribute information

**REGISTERED SURVEYOR'S CERTIFICATION**  
 TILLERMAN - STAGE 2  
 Saunders Havill Group Pty Ltd, Registered Surveyor, hereby certify that the vertical and horizontal locations and dimensions shown on this plan are a true and correct record and were located by survey.  
 \_\_\_\_\_  
 Authorised Signatory      Reg. Surveyor No. 4611      Date: Preliminary

**ADAC Verification Plot**

Project Name: Tillerman - Stage 2	ADAC version: 5.01
Description: Subdivision	Horizontal coordinates: MGA56 (MGA94)
Works Approval ID: OW/223/2022	Vertical datum: AHD
Receiver: Logan City Council	Notes: Vertical Origin: PM70079, RL 57.043 AHD
Construction date: 2024-01-07	Surveyor: Saunders Havill Group (Reg ID 4611)
Status: As Constructed	Engineer: Colliers Engineering & Design

Note: See ADAC xml file for full attribute information

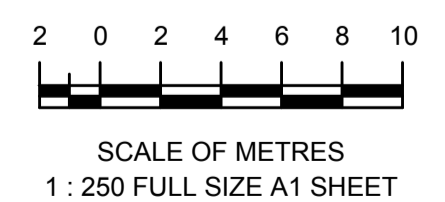

SEE SHEET 2

<b>A1</b>	REV NO	DATE	REVISION PURPOSE / DESCRIPTION	DRAWN	RPEQ	RPEQ No	DRAWN	CM	17.10.2023	 <small>Saunders Havill Group Pty Ltd ABN 04 644 970 949 Brisbane - Springfield          head office 9 Thompson St Bowen Hills Q 4006          phone 180 023 SHG web www.saundershavill.com          #surveying #townplanning #urban design #environmental management #landscape architecture</small>	 	<b>TILLERMAN - STAGE 2</b> <b>PARK RIDGE ROAD, PARK RIDGE</b> <b>PLAN OF ADAC SURVEY DATA</b> <b>WATER RETICULATION OW/223/2022</b>		DRAWING STATUS	
	A	23.11.23	Original Issue											<b>AS CONSTRUCTED</b> SHEET 1 OF 3 SHEETS DRAWING NO. 10652 S 27 AC A      REV. A	

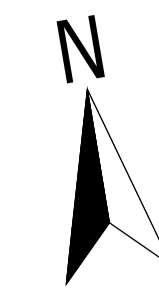

HEWING PLACE

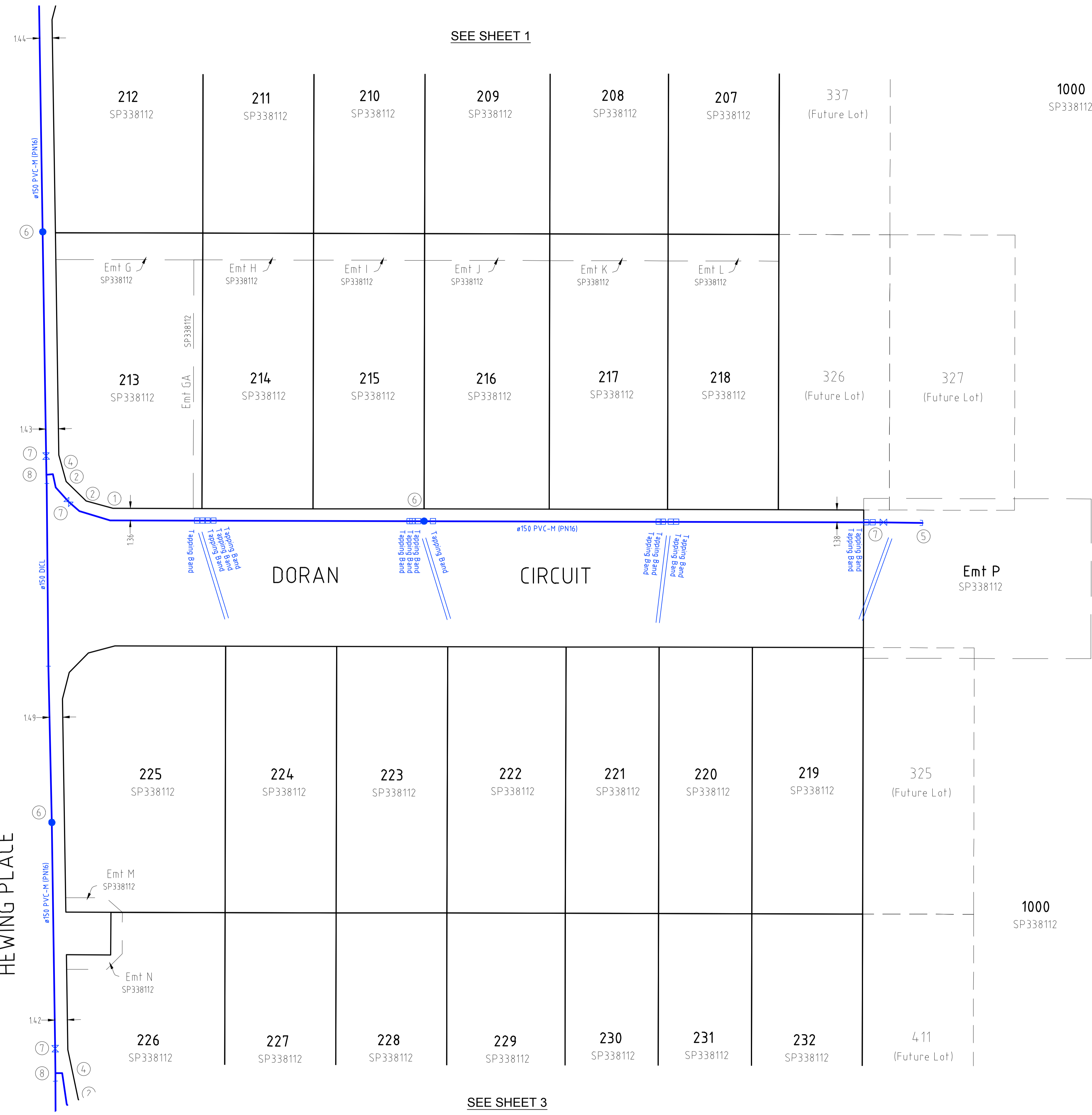

2  
RP137533

SEE SHEET 1

SEE SHEET 3

SCHEDULE OF FITTINGS

1	Ø150 11.25° Bend
2	Ø150 22.5° Bend
3	Ø150 45° Bend
4	Ø150 90° Bend
5	Ø150 Dead End Cap
6	Ø150 Hydrant
7	Ø150 Valve
8	Ø150 x Ø150 Tee

WATER FITTINGS LEGEND

	Hydrant
	Valve
	Bend
	Water Fitting
	Dead End Cap
	Reducer
	Water Meter
	Conduit Crossing and Service Pipe

Note: See ADAC xml file for full attribute information

**REGISTERED SURVEYOR'S CERTIFICATION**  
TILLERMAN - STAGE 2

Saunders Havill Group Pty Ltd, Registered Surveyor, hereby certify that the vertical and horizontal locations and dimensions shown on this plan are a true and correct record and were located by survey.

*James Cole*  
Authorised Signatory      Reg. Surveyor No. 4611      Date: Preliminary

ADAC Verification Plot

Project Name: Tillerman - Stage 2	ADAC version: 5.01
Description: Subdivision	Horizontal coordinates: MGA56 (MGA94)
Works Approval ID: OW/223/2022	Vertical datum: AHD
Receiver: Logan City Council	Notes: Vertical Origin: PM70079, RL 57.043 AHD
Construction date: 2024-01-07	Surveyor: Saunders Havill Group (Reg ID 4611)
Status: As Constructed	Engineer: Colliers Engineering & Design

Note: See ADAC xml file for full attribute information

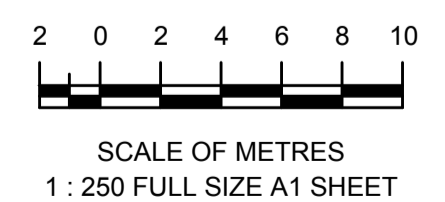

A1

REV NO	DATE	REVISION PURPOSE / DESCRIPTION	DRAWN	RPEQ	RPEQ No
A	23.11.23	Original Issue			

DRAWN	CM	17.10.2023
CHECKED	-	-
APPROVED		
INITIALS		DATE

**saunders havill group**  
Saunders Havill Group Pty Ltd ABN 04 644 970 949  
head office 9 Thompson St Bowen Hills Q 4006  
phone 1800 823 514 web www.saundershavill.com

Drawing No: 10652 S 27 AC A



**TILLERMAN - STAGE 2**  
**PARK RIDGE ROAD, PARK RIDGE**

**PLAN OF ADAC SURVEY DATA**  
**WATER RETICULATION OW/223/2022**

DRAWING STATUS <b>AS CONSTRUCTED</b>	
SHEET 2 OF 3 SHEETS	
DRAWING NO. 10652 S 27 AC A	REV. A

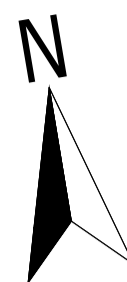

SEE SHEET 2

HEWING PLACE

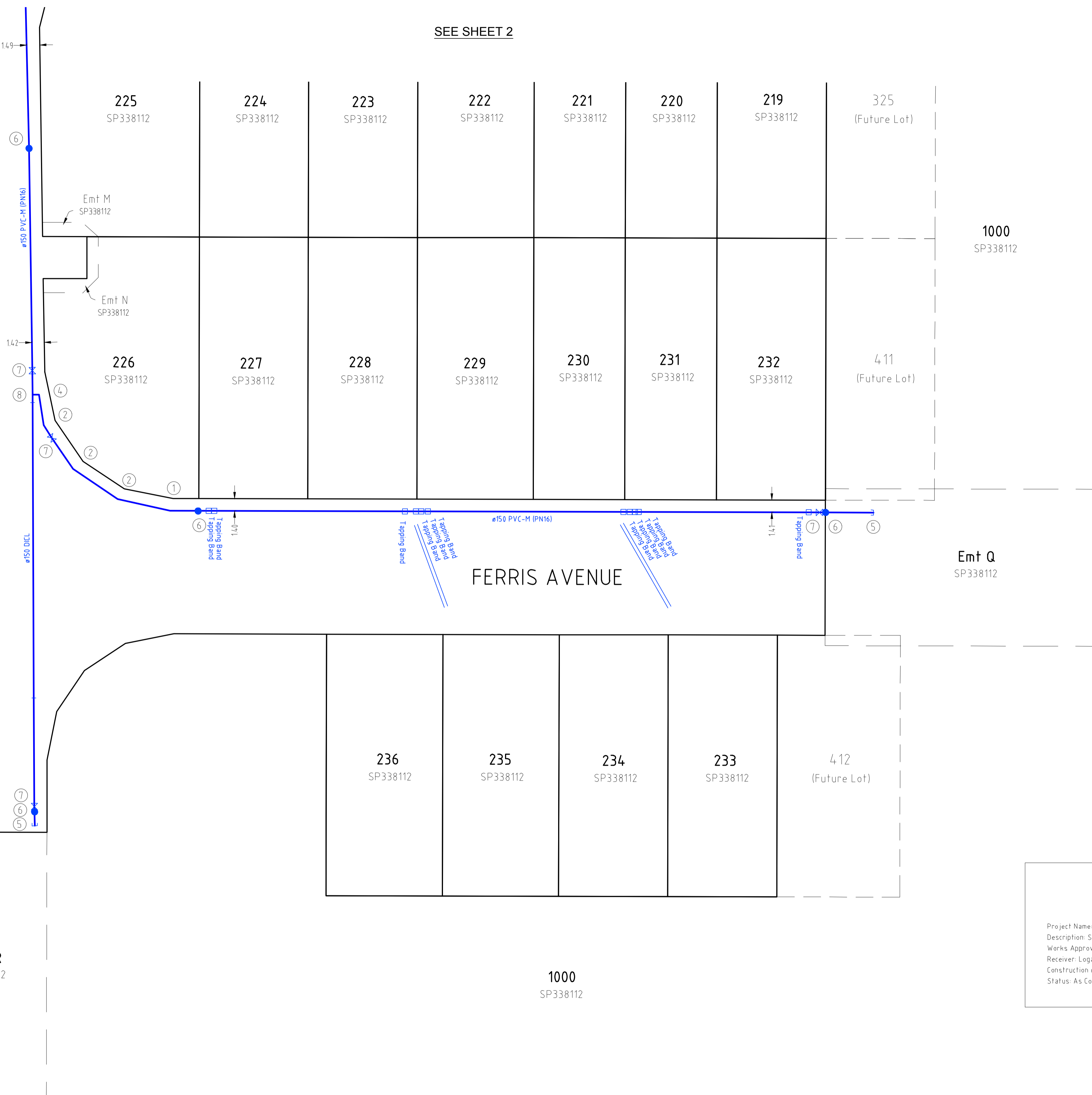

SCHEDULE OF FITTINGS

1	Ø150 11.25° Bend
2	Ø150 22.5° Bend
3	Ø150 45° Bend
4	Ø150 90° Bend
5	Ø150 Dead End Cap
6	Ø150 Hydrant
7	Ø150 Valve
8	Ø150 x Ø150 Tee

WATER FITTINGS LEGEND

	Hydrant
	Valve
	Bend
	Water Fitting
	Dead End Cap
	Reducer
	Water Meter
	Conduit Crossing and Service Pipe

Note: See ADAC xml file for full attribute information

**REGISTERED SURVEYOR'S CERTIFICATION**  
 TILLERMAN - STAGE 2

Saunders Havill Group Pty Ltd, Registered Surveyor, hereby certify that the vertical and horizontal locations and dimensions shown on this plan are a true and correct record and were located by survey.

*[Signature]*  
 Authorised Signatory      Reg. Surveyor No. 4611      Date: Preliminary

ADAC Verification Plot

Project Name: Tillerman - Stage 2	ADAC version: 5.01
Description: Subdivision	Horizontal coordinates: MGA56 (MGA94)
Works Approval ID: OW/223/2022	Vertical datum: AHD
Receiver: Logan City Council	Notes: Vertical Origin: PM70079, RL 57.043 AHD
Construction date: 2024-01-07	Surveyor: Saunders Havill Group (Reg ID 4611)
Status: As Constructed	Engineer: Colliers Engineering & Design

Note: See ADAC xml file for full attribute information

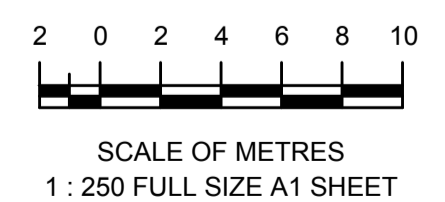

A1

REV NO	DATE	REVISION PURPOSE / DESCRIPTION	DRAWN	RPEQ	RPEQ No
A	23.11.23	Original Issue			

DRAWN	CM	17.10.2023
CHECKED	-	-
APPROVED		

**saunders havill group**  
 Saunders Havill Group Pty Ltd ABN 54 644 972 949  
 head office 9 Thompson St Bowen Hills Q 4006  
 phone 1800 823 5143 web www.saundershavill.com

Drawing No: 10652 S 27 AC A

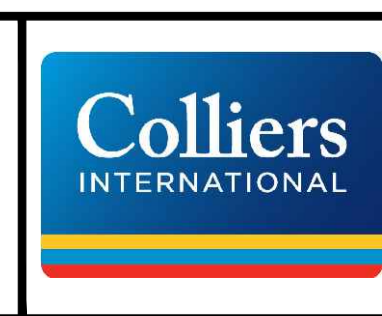

**TILLERMAN - STAGE 2**  
**PARK RIDGE ROAD, PARK RIDGE**

**PLAN OF ADAC SURVEY DATA**  
**WATER RETICULATION OW/223/2022**

DRAWING STATUS <b>AS CONSTRUCTED</b>	
SHEET 3 OF 3 SHEETS	
DRAWING NO. 10652 S 27 AC A	REV. A

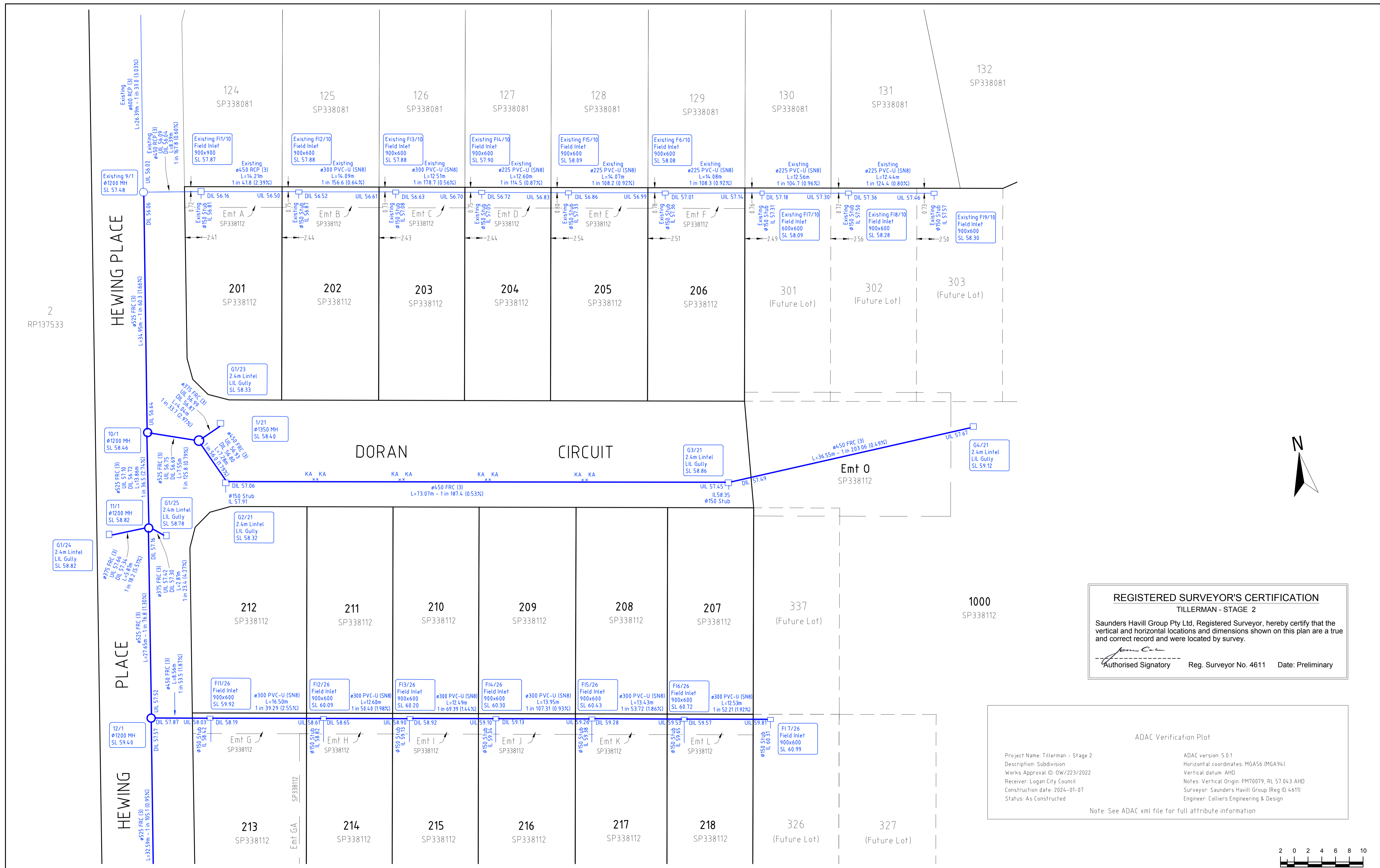

**REGISTERED SURVEYOR'S CERTIFICATION**  
 TILLERMAN - STAGE 2  
 Saunders Havill Group Pty Ltd, Registered Surveyor, hereby certify that the vertical and horizontal locations and dimensions shown on this plan are a true and correct record and were located by survey.  
 \_\_\_\_\_  
 Authorised Signatory      Reg. Surveyor No. 4611      Date: Preliminary

ADAC Verification Plot  
 Project Name: Tillerman - Stage 2  
 Description: Subdivision  
 Works Approval ID: OW/223/2022  
 Receiver: Logan City Council  
 Construction date: 2024-01-07  
 Status: As Constructed  
 ADAC version: 5.0.1  
 Horizontal coordinates: MGA56 (MGA94)  
 Vertical datum: AHD  
 Notes: Vertical Origin: PM70079, RL 57.043 AHD  
 Surveyor: Saunders Havill Group (Reg ID 4611)  
 Engineer: Colliers Engineering & Design  
 Note: See ADAC xml file for full attribute information

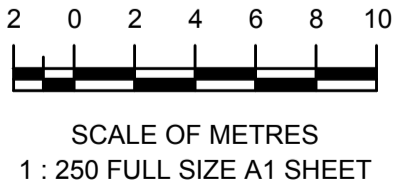

SEE SHEET 2

A1	REV NO	DATE	REVISION PURPOSE / DESCRIPTION	DRAWN	RPEQ	RPEQ No	DRAWN	RPEQ	RPEQ No	INITIALS	DATE
	A	23.11.23	Original Issue								
							 <small>Saunders Havill Group Pty Ltd ABN 24 644 972 949          head office 9 Thompson St Bowen Hills Q 4006          phone 1800 823 514 web www.saundershavill.com          ■ surveying ■ town planning ■ urban design ■ environmental management ■ landscape architecture</small>				
<b>TILLERMAN - STAGE 2</b> <b>PARK RIDGE ROAD, PARK RIDGE</b> <b>PLAN OF ADAC SURVEY DATA</b> <b>STORMWATER RETICULATION    OW/223/2022</b>										DRAWING STATUS <b>AS CONSTRUCTED</b> SHEET 1 OF 4 SHEETS DRAWING NO. 10652 S 28 AC REV. A	

SEE SHEET 1

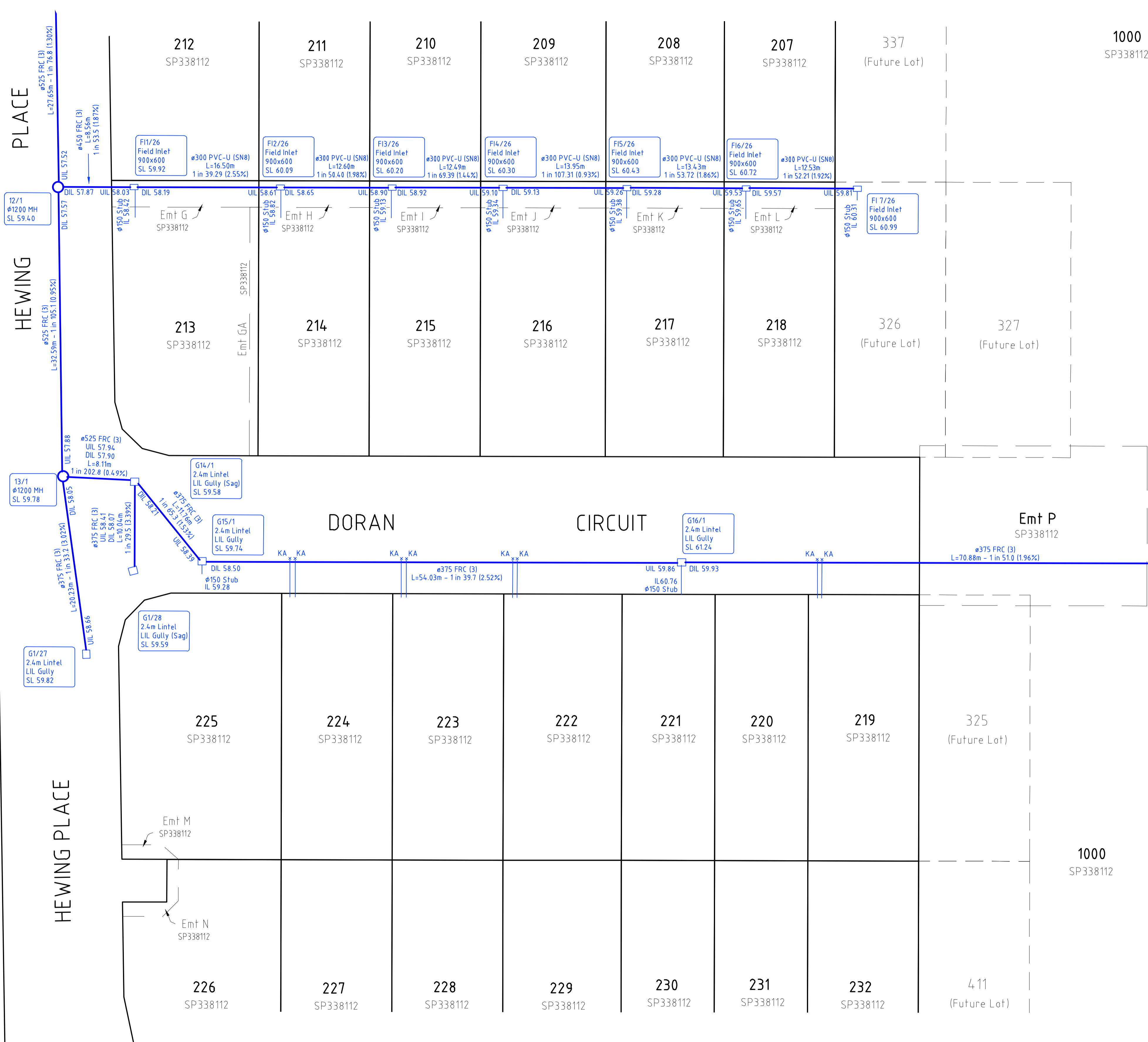
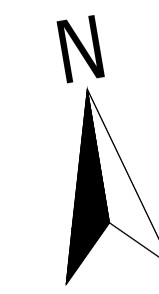

2  
RP137533

A1

REV NO	DATE	REVISION PURPOSE / DESCRIPTION	DRAWN	RPEQ	RPEQ No
A	23.11.23	Original Issue			

DRAWN	CM	23/11/2023
CHECKED	-	-
APPROVED		

**saunders havill group**  
 Saunders Havill Group Pty Ltd ABN 24 644 972 949  
 head office 9 Thompson St Bowen Hills Q 4006  
 phone 1800 823 5143 web www.saundershavill.com  
 ■ surveying ■ town planning ■ urban design ■ environmental management ■ landscape architecture

**Colliers INTERNATIONAL**

**TILLERMAN**  
PARK RIDGE

**TILLERMAN - STAGE 2**  
**PARK RIDGE ROAD, PARK RIDGE**  
**PLAN OF ADAC SURVEY DATA**  
**STORMWATER RETICULATION OW/223/2022**

**DRAWING STATUS**  
**AS CONSTRUCTED**  
 SHEET 2 OF 4 SHEETS  
 DRAWING NO. 10652 S 28 AC  
 REV. A

**REGISTERED SURVEYOR'S CERTIFICATION**  
 TILLERMAN - STAGE 2  
 Saunders Havill Group Pty Ltd, Registered Surveyor, hereby certify that the vertical and horizontal locations and dimensions shown on this plan are a true and correct record and were located by survey.  
 \_\_\_\_\_  
 Authorised Signatory Reg. Surveyor No. 4611 Date: Preliminary

**ADAC Verification Plot**

Project Name: Tillerman - Stage 2	ADAC version: 5.01
Description: Subdivision	Horizontal coordinates: MGA56 (MGA94)
Works Approval ID: OW/223/2022	Vertical datum: AHD
Receiver: Logan City Council	Notes: Vertical Origin: PM70079, RL 57.043 AHD
Construction date: 2024-01-07	Surveyor: Saunders Havill Group (Reg ID 4611)
Status: As Constructed	Engineer: Colliers Engineering & Design

Note: See ADAC xml file for full attribute information

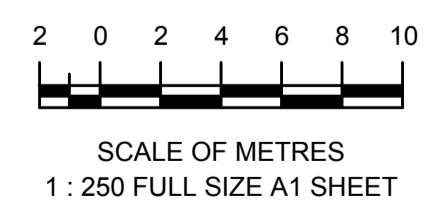

SEE SHEET 3



SEE SHEET 2



HEWING PLACE

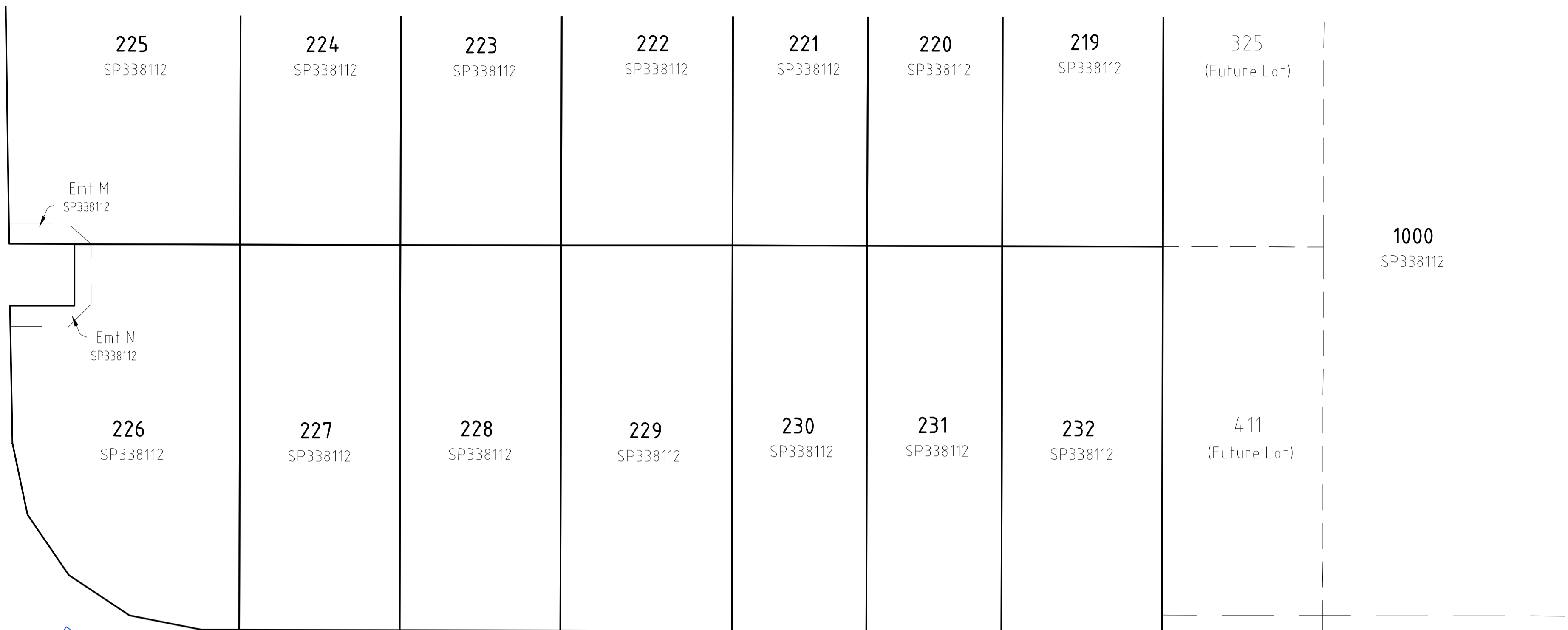

1000  
SP338112

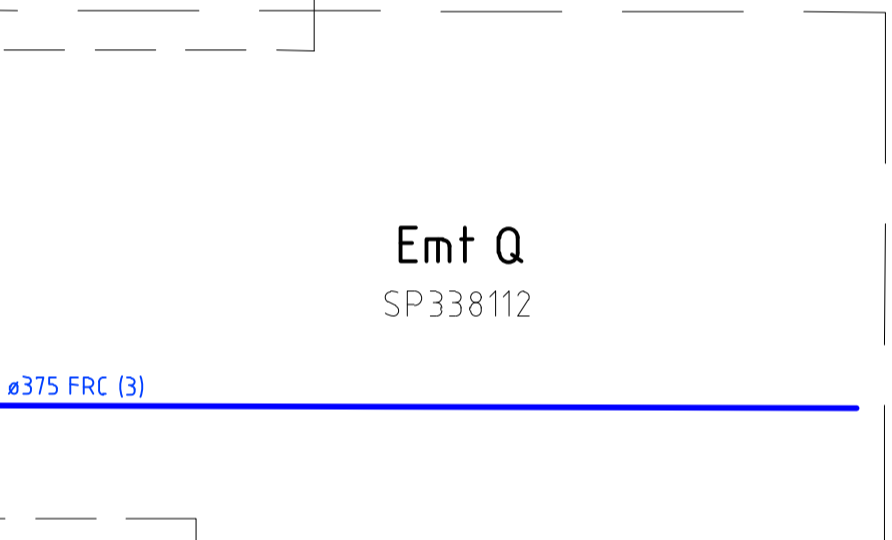

FERRIS AVENUE

Emit Q  
SP338112

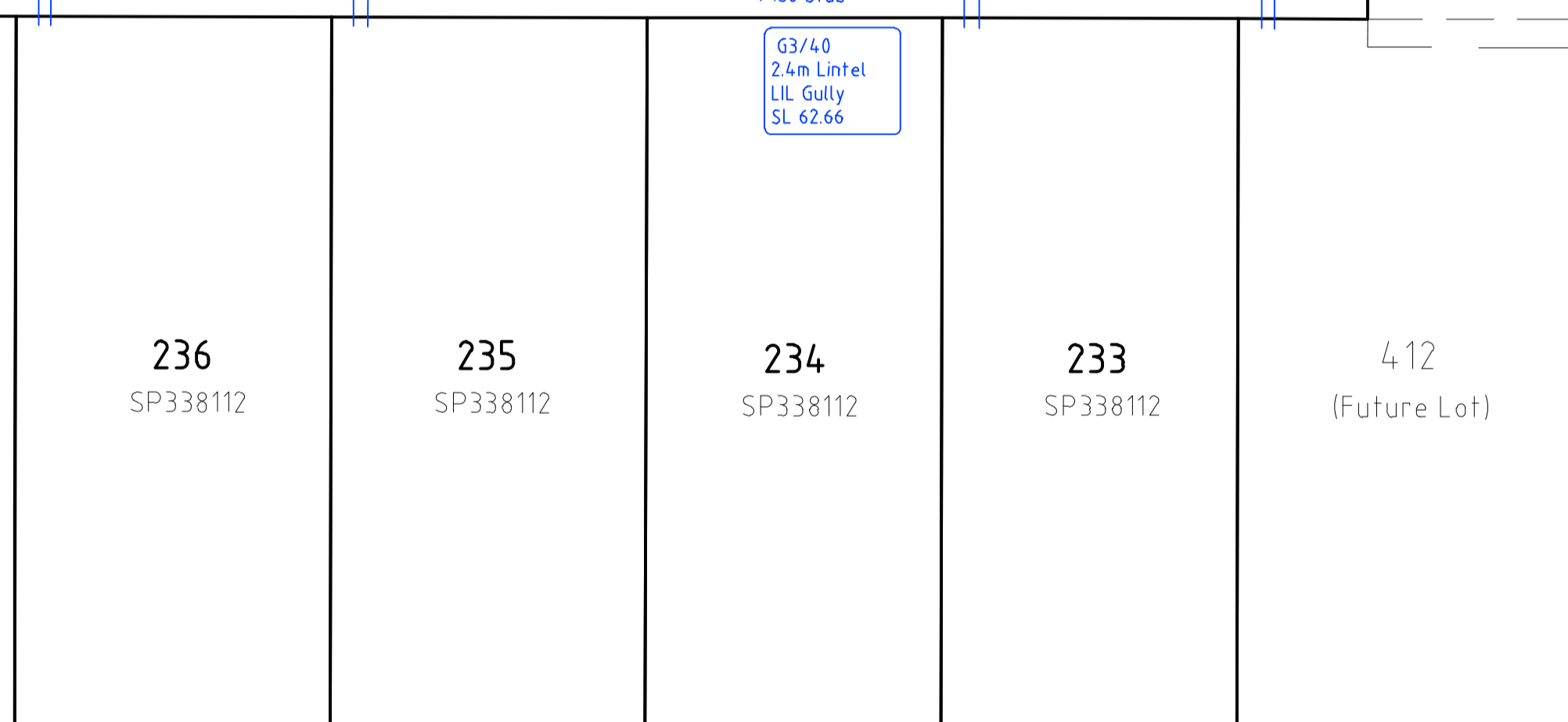

1000  
SP338112

Emit R  
SP338112

SEE SHEET 4

**REGISTERED SURVEYOR'S CERTIFICATION**  
TILLERMAN - STAGE 2

Saunders Havill Group Pty Ltd, Registered Surveyor, hereby certify that the vertical and horizontal locations and dimensions shown on this plan are a true and correct record and were located by survey.

*John Cole*  
Authorised Signatory Reg. Surveyor No. 4611 Date: Preliminary

ADAC Verification Plot

Project Name: Tillerman - Stage 2  
Description: Subdivision  
Works Approval ID: OW/223/2022  
Receiver: Logan City Council  
Construction date: 2024-01-07  
Status: As Constructed

ADAC version: 5.01  
Horizontal coordinates: MGA56 (MGA94)  
Vertical datum: AHD  
Notes: Vertical Origin: PM70079, RL 57.043 AHD  
Surveyor: Saunders Havill Group (Reg ID 4611)  
Engineer: Colliers Engineering & Design

Note: See ADAC xml file for full attribute information

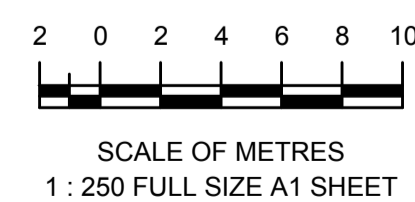

<b>A1</b>	REV NO	DATE	REVISION PURPOSE / DESCRIPTION	DRAWN	RPEQ	RPEQ No	INITIALS	DATE
	A	23.11.23	Original Issue					

DRAWN	CM	23/11/2023
CHECKED	-	-
APPROVED		

**saunders havill group**  
Saunders Havill Group Pty Ltd ABN 04 644 970 949  
head office 9 Thompson St Bowen Hills Q 4006  
phone 1800 823 SHG web www.saundershavill.com  
#surveying #townplanning #urban design #environmental management #landscape architecture

Drawing No: 10652 S 28 AC A

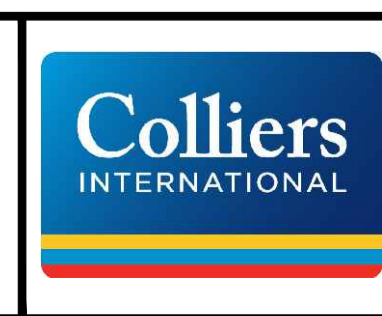

**TILLERMAN - STAGE 2**  
**PARK RIDGE ROAD, PARK RIDGE**  
**PLAN OF ADAC SURVEY DATA**  
**STORMWATER RETICULATION OW/223/2022**

DRAWING STATUS <b>AS CONSTRUCTED</b>	
SHEET 3 OF 4 SHEETS	
DRAWING NO. 10652 S 28 AC	REV. A

