

Land Title Act 1994 ; Land Act 1994
Form 21 Version 4

SURVEY PLAN

Sheet 1 of 7

Original information compiled from SP338112 in the Department of Resources.

See Sheet 7 for Reference Marks Table.

See Sheet 7 for Reinstatement Report.

Peg placed at all new corners, unless otherwise stated.

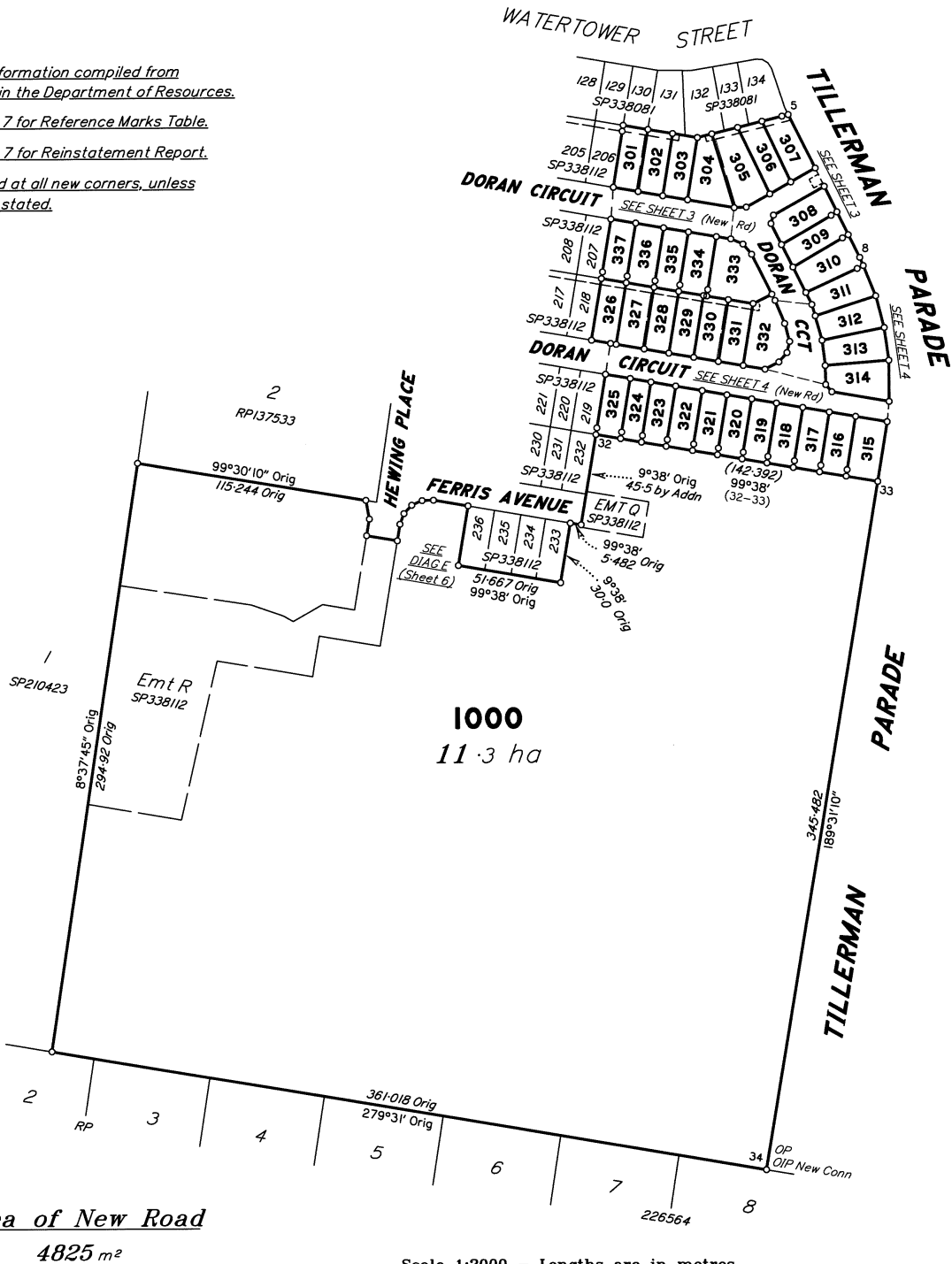

Area of New Road
4825 m²

Scale 1:2000 - Lengths are in metres.

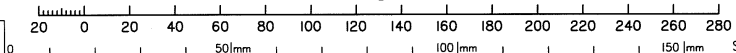

SAUNDERS HAVILL GROUP PTY LTD (ACN 144 972 948) hereby certify that the land comprised in this plan was surveyed by the corporation, by John Hendrik LOEWYK, surveying associate, for whose work the corporation accepts responsibility, under the supervision of James Walter CARTER, cadastral surveyor, and that the plan is accurate, that the said survey was performed in accordance with the Survey and Mapping Infrastructure Act 2003 and Surveyors Act 2003 and associated Regulations and Standards and that the said survey was completed on 19/01/2024



M. Kleine
Authorised Signatory
James Carter
Authorised Signatory
Date: 20/01/2024

Plan of Lots 301-337 & 1000 and Emts A & AA in Lot 301, Emts B-D in Lots 302-304 respectively, Emts E & EA in Lot 305, Emt F in Lot 306, Emt G in Lot 307, Emt H in Lot 326, Emts I & IA in Lot 327, Emt J in Lot 328, Emt K in Lot 329, Emts L & LA in Lot 330, Emt M in Lot 331 & Emt N in Lot 332

Canceling Lot 1000 on SP338112

LOCAL GOVERNMENT: LOGAN CITY LOCALITY: PARK RIDGE

Meridian: MGA (Zone 56) vide IS308387

Survey Records: No

Scale: 1:2000

Format: STANDARD



SP341893

SAUNDERS HAVILL GROUP

10652-SP341893.DWG MS

WARNING : Folded or Mutilated Plans will not be accepted.
Plans may be rolled.
Information may not be placed in the outer margins.

723187117

EL 400 \$5,661.39
12/04/2024 13:23:15

(Dealing No.)

4. Lodged by

(Include address, phone number, email, reference, and Lodger Code)

Existing		Created		
Title Reference	Description	New Lots	Road	Secondary Interests
51333537	Lot 1000 on SP338112	301-337 & 1000	New Rd	Emts A-N, AA, EA, IA & LA

ENCUMBRANCE EASEMENT ALLOCATIONS

Easement	Lots to be Encumbered
722867203 (Emt R on SP338112)	1000
722867204 (Emt Q on SP338112)	1000

BENEFIT EASEMENT ALLOCATIONS

Easement	Lots Fully Benefited	Lots Partially Benefited
722867206 (Emt A on SP338112)	301-337 & 1000	
722867207 (Emt B on SP338112)	301-337 & 1000	
722867208 (Emt C on SP338112)	301-337 & 1000	
722867209 (Emt D on SP338112)	301-337 & 1000	
722867210 (Emt E on SP338112)	301-337 & 1000	
722867211 (Emt F on SP338112)	301-337 & 1000	
722867212 (Emt G on SP338112)	301-337 & 1000	
722867213 (Emt H on SP338112)	301-337 & 1000	
722867214 (Emt I on SP338112)	301-337 & 1000	
722867215 (Emt J on SP338112)	301-337 & 1000	
722867216 (Emt K on SP338112)	301-337 & 1000	
722867217 (Emt L on SP338112)	301-337 & 1000	

722867204 (Easement O on SP338112) to be surrendered prior to registration of this plan.
722867204 (Easement P on SP338112) to be surrendered prior to registration of this plan.

301-337 & 1000	Por 37v
Lots	Orig

2. Orig Grant Allocation :

3. References :

Dept File :
Local Govt :
Surveyor : 10652 - Stage 3

5. Passed & Endorsed :

By: SAUNDERS HAVILL GROUP PTY LTD
Date: 20/02/2024
Signed: *[Signature]*
Designation: Endorsing Officer

6. Building Format Plans only.
I certify that :
* As far as it is practical to determine, no part of the building shown on this plan encroaches onto adjoining lots or road.
* Part of the building shown on this plan encroaches onto adjoining * lots and road
.....
Cadastral Surveyor/Director * Date
~~delete words not required~~

7. Lodgement Fees :

Survey Deposit \$
Lodgement \$
..... New Titles \$
Photocopy \$
Postage \$
TOTAL \$

8. Insert Plan Number **SP341893**

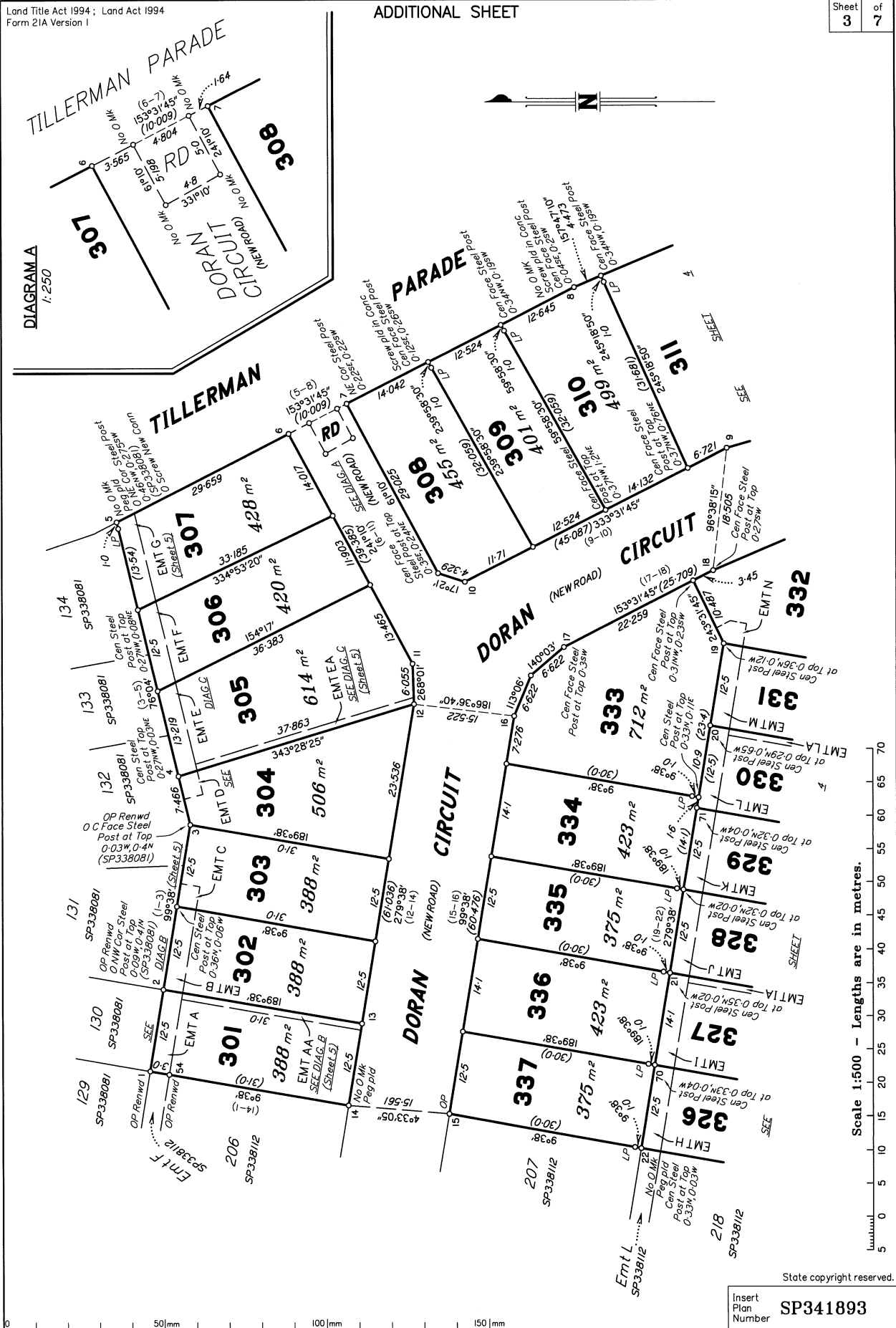
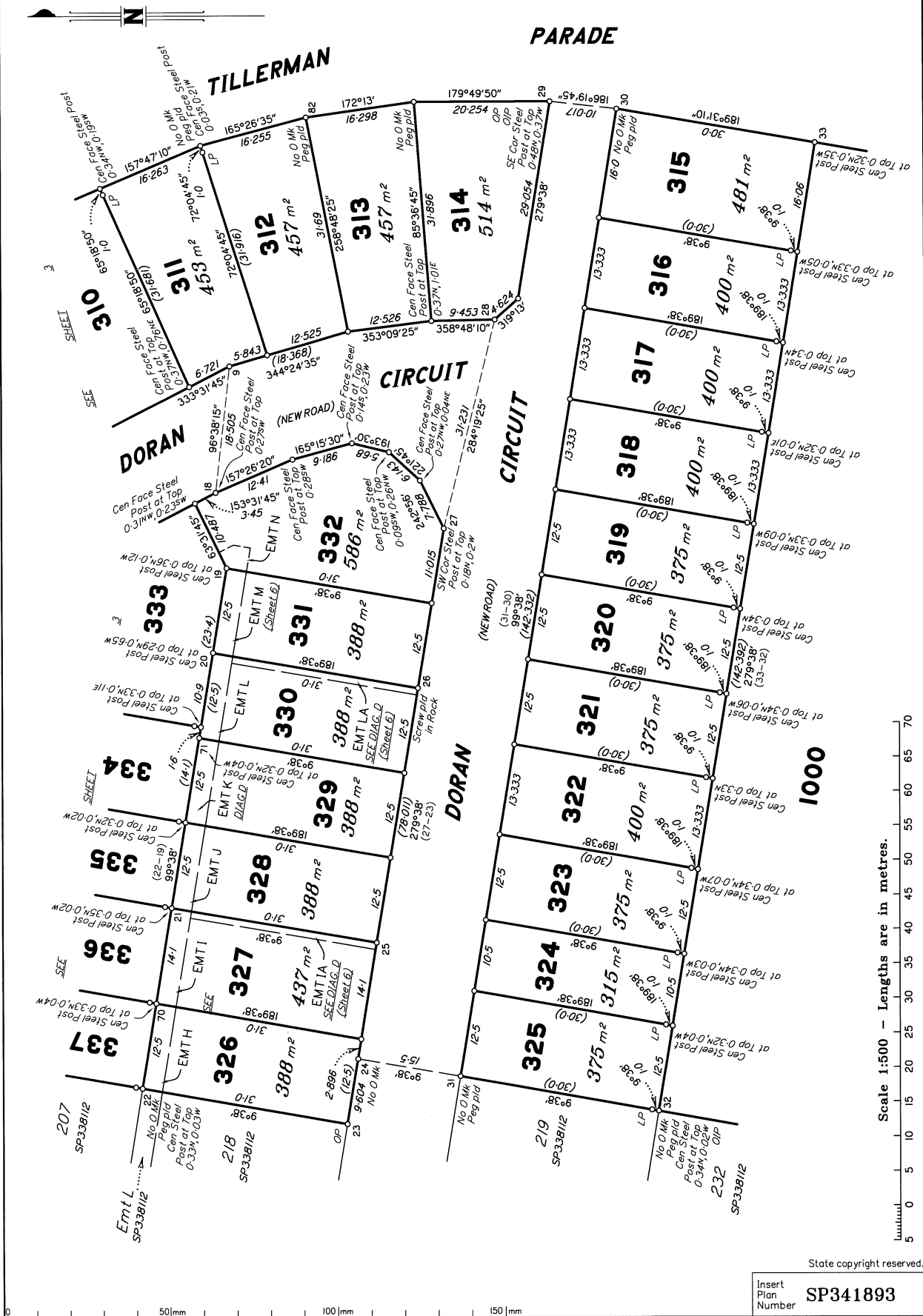

DIAGRAM A
1:250

Scale 1:500 - Lengths are in metres.

State copyright reserved.
Insert
Plan
Number
SP341893



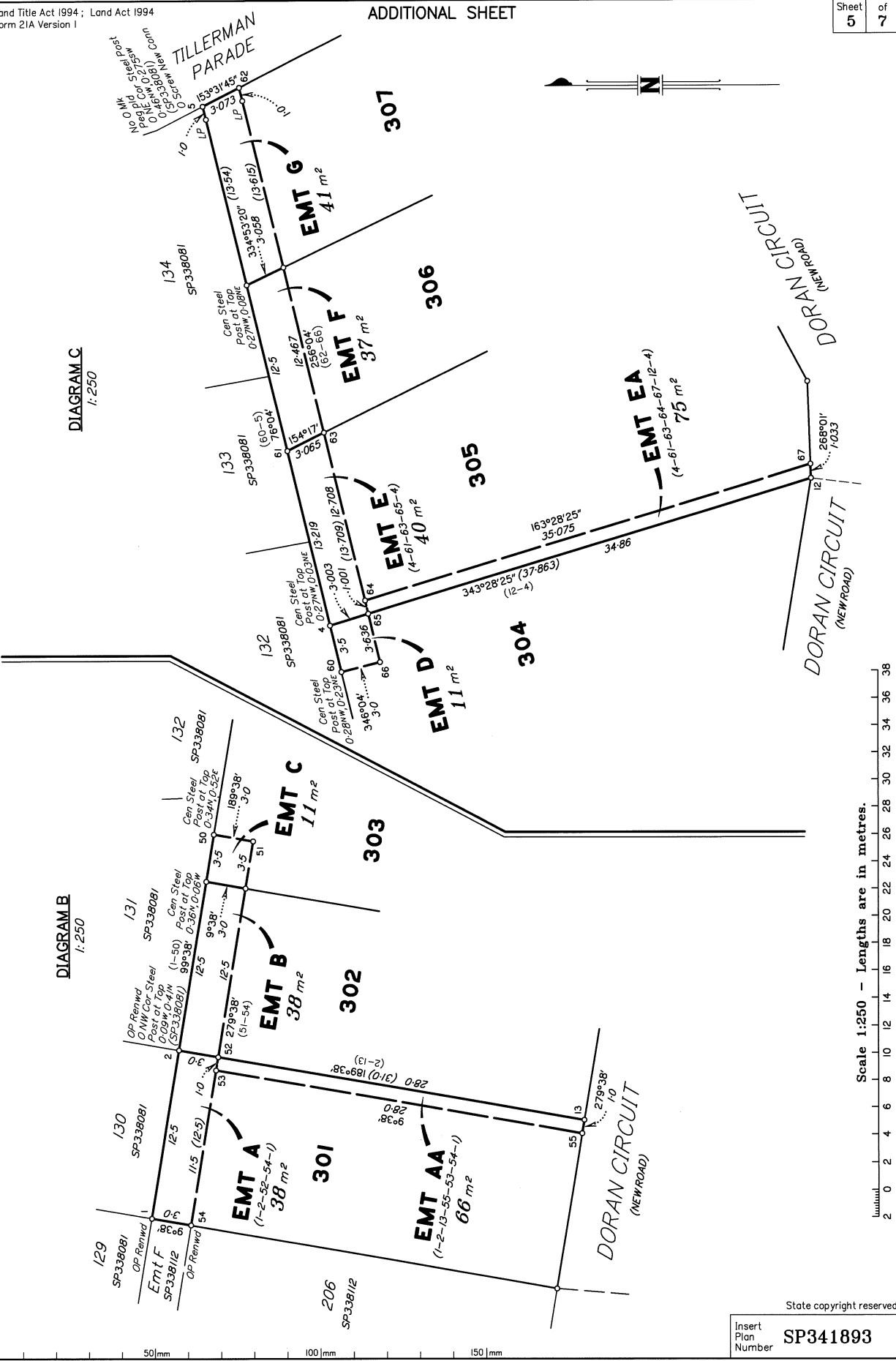
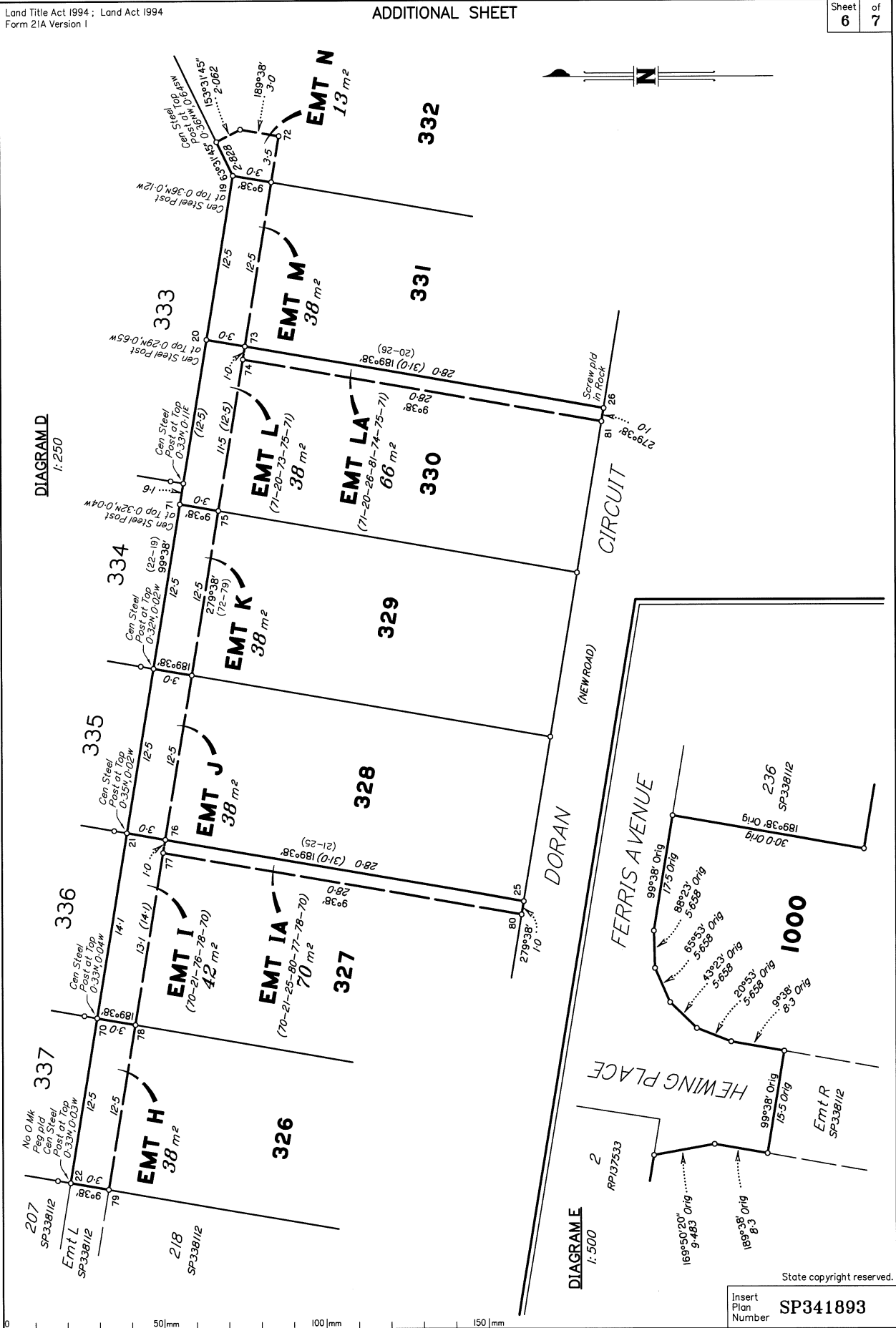

DIAGRAM C
1:250

DIAGRAM B
1:250

Scale 1:250 - Lengths are in metres.

State copyright reserved.
Insert Plan Number
SP341893



REFERENCE MARKS

STN	TO	ORIGIN	BEARING	DIST
5	O Screw in Kerb New Conn	34/SP338081	28°54'45"	25.792
7	Screw in Kerb		37°54'	4.319
8	Pin		72°14'30"	24.998
10	Pin		318°39'	3.144
11	Screw in Conc		155°53'	6.282
14	Screw in Channel		191°43'	4.117
15	Screw in Channel		345°28'	4.251
16	Screw in Channel		78°59'	7.553
18	Screw in Channel		22°39'	5.417
24	Screw in Channel		153°36'	5.043
27	Screw in Channel		110°20'	7.404
28	Screw in Conc		268°44'	14.138
29	OIP	20/SP338081	94°13'	2.127
29	Screw in Conc		263°22'30"	7.941
30	Screw in Conc		295°34'	8.694
31	Screw in Channel		11°12'	4.147
32	OIP New Conn	23/SP338112	245°26'	34.896
33	Pin		84°17'20"	22.429
34	OIP New Conn	2/IS308387	84°07'30"	16.566
82	Pin		351°14'	4.789

REINSTATEMENT REPORT

- SP341893 is stage 3 of a multiple staged land development.
SP338112 was stage 2 and SP338081 stage 1.
- IS308387 reinstated the external boundaries of the subject land, Lot 3 on RPI37533.
- See IS308387 for connection to Datum.
- All original corners on SP341893 are fixed by original marks and occupations in agreement with IS308387, SP338081 & SP338112.

State copyright reserved.

Insert
Plan
Number
SP341893