

SEE SHEET 8 FOR  
EASEMENTS  
SUMMARY

See Sheet 7 for MGA Coordinates Table.

See Sheet 7 for Reference Marks and Permanent Marks Tables.

See Sheet 7 for Reinstatement Report.

Original information compiled from SP344926 in the Department of Resources.

Peg placed at all new corners, unless otherwise stated.

Area of New Road  
**6288 m<sup>2</sup>**

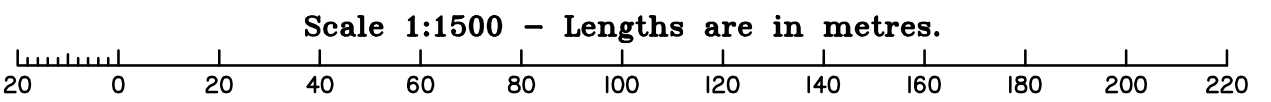

Preliminary Issues			
No.	Drawn	Checked	Date
A	TG	PS	08/05/24
			Issue for disclosures
			Comments

0 50m 100m 150m State copyright reserved.

**Plan of Lots 701-736 & 1000**  
and Emt D in Lot 717, Emt E in Lot 718, Emts F & G in Lot 1000, Emts P & PA in Lot 704, Emts Q-V in Lots 705-710 respectively, Emts W & X in Lots 713 & 714 respectively, Emts Y & YA in Lot 715, Emt Z in Lot 716 and Emts AA-AR in Lots 719-736 respectively.  
Cancelling Lot 1000 on SP344926

LOCAL GOVERNMENT: LOGAN CITY  
LOCALITY: PARK RIDGE

Meridian: MGA (Zone 56) wide ...

Scale: **1:1500**

Format: **STANDARD**

**PRELIMINARY**

SP344927

Survey Records: No

Prelim print date: 13/05/2024

**WARNING : Folded or Mutilated Plans will not be accepted.  
Plans may be rolled.  
Information may not be placed in the outer margins.**

(Dealing No.)

4. Lodged by

(Include address, phone number, email, reference, and Lodger Code)

I. Existing		Created		
Title Reference	Description	New Lots	Road	Secondary Interests
	Lot 1000 on SP344926	701-736 & 1000	New Rd	Emts D-G, P-Z, AA-AR, PA & YA

**ENCUMBRANCE EASEMENT ALLOCATIONS**

Easement	Lots to be Encumbered
To Issue (Emt M on SP344926)	717
To Issue (Emt O on SP344926)	1000

**BENEFIT EASEMENT ALLOCATIONS**

Easement	Lots Fully Benefited	Lots Partially Benefited
To Issue (Emt J on SP344915)	701-736 & 1000	
To Issue (Emt B on SP344926)	701-736 & 1000	

To Issue (Emt K on SP344915) is to be surrendered prior to registration of this plan.

To Issue (Emt L on SP344915) is to be surrendered prior to registration of this plan.

To Issue (Emt N on SP344926) is to be surrendered prior to registration of this plan.

Note: After registration of this plan, the benefit of Emt J on SP344915 is to be surrendered from all lots except Lots 704-710

Note: After registration of this plan, the benefit of Emt B on SP344926 is to be surrendered from all lots except Lot 1000

**PRELIMINARY**

**6. Building Format Plans only.**

I certify that :  
 \* As far as it is practical to determine, no part of the building shown on this plan encroaches onto adjoining lots or road;  
 \* Part of the building shown on this plan encroaches onto adjoining \* lots and road

.....  
 Cadastral Surveyor/Director\* Date

\*delete words not required

**7. Lodgement Fees :**

Survey Deposit	\$ .....
Lodgement	\$ .....
.....New Titles	\$ .....
Photocopy	\$ .....
Postage	\$ .....
<b>TOTAL</b>	<b>\$ .....</b>

8. Insert Plan Number **SP344927**

701-736 & 1000	Por 37v
Lots	Orig

2. Orig Grant Allocation :

3. References :  
 Dept File :  
 Local Govt :  
 Surveyor : 10652 - Stage 7

5. Passed & Endorsed :  
 By: SAUNDERS HAVILL GROUP PTY LTD  
 Date :  
 Signed :  
 Designation : Endorsing Officer

PRELIMINARY

Scale 1:500 - Lengths are in metres.

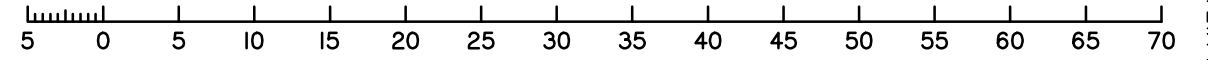

Land Title Act 1994; Land Act 1994  
Form 21A Version 1

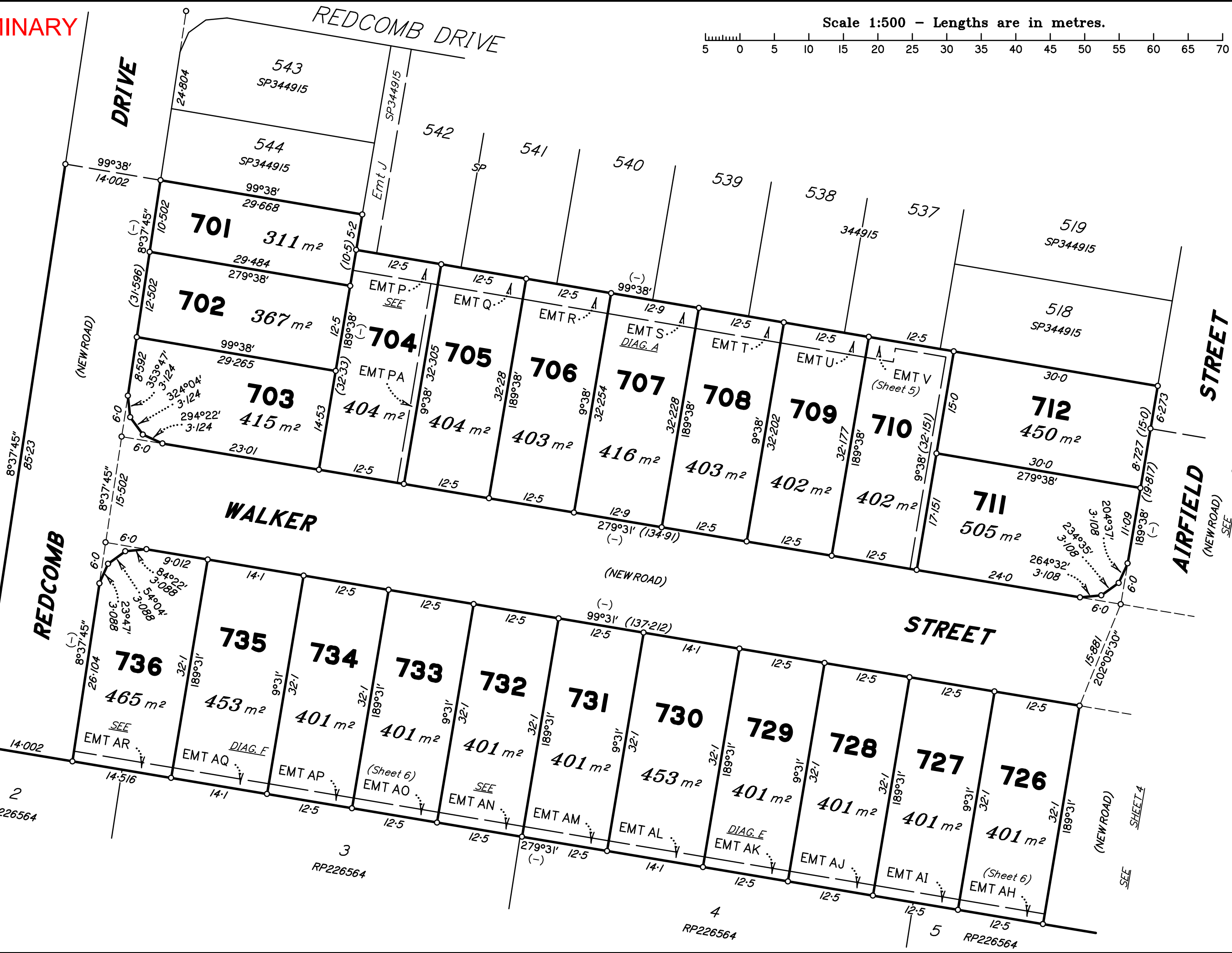
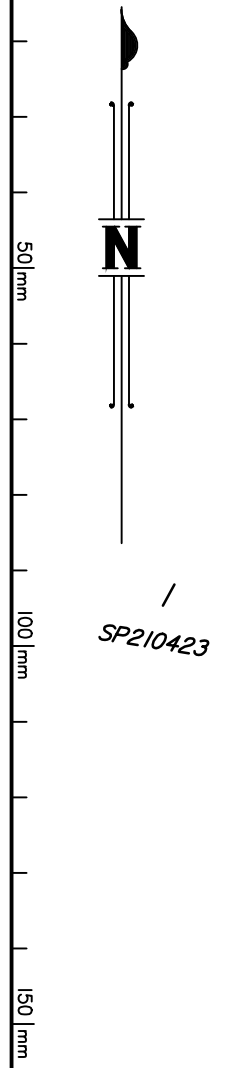

ADDITIONAL SHEET  
SEE SHEET 4

Insert Plan Number  
**SP344927**  
State copyright reserved.

Sheet 3 of 7

PRELIMINARY

Scale 1:500 - Lengths are in metres.

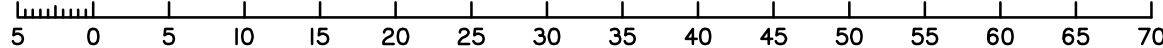

Land Title Act 1994; Land Act 1994  
Form 21A Version 1

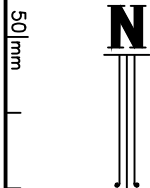

50mm

100mm

150mm



ADDITIONAL SHEET

Insert  
Plan  
Number  
**SP344927**

State copyright reserved.

5  
RP226564

6  
RP226564

7  
RP226564

Sheet  
4  
of  
7

DIAGRAM A  
1:250

Scale 1:250 - Lengths are in metres.

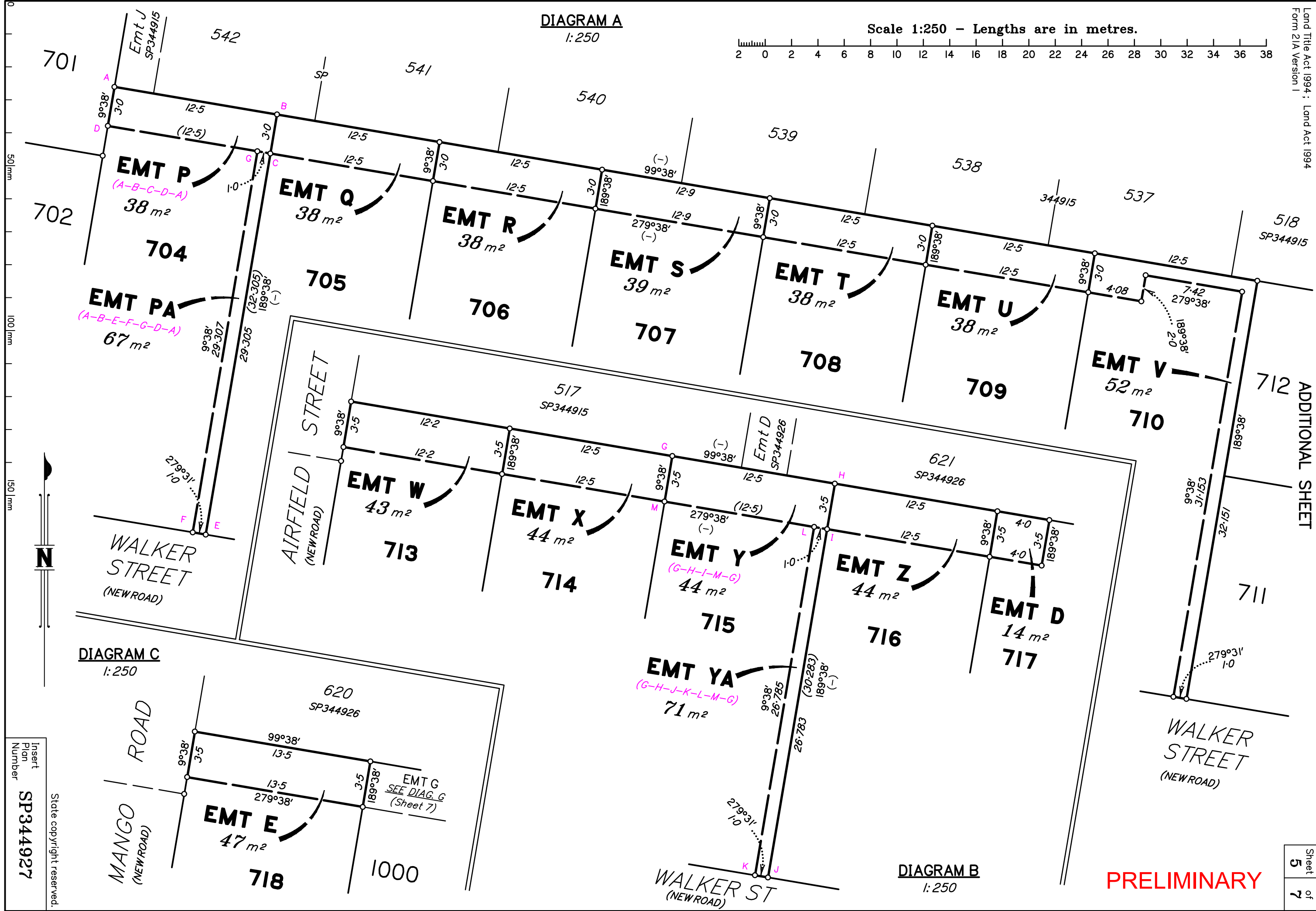
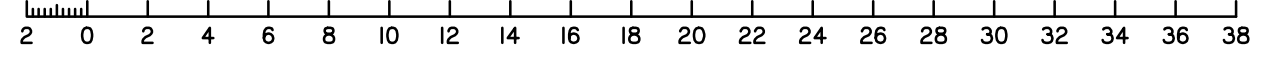

DIAGRAM C  
1:250

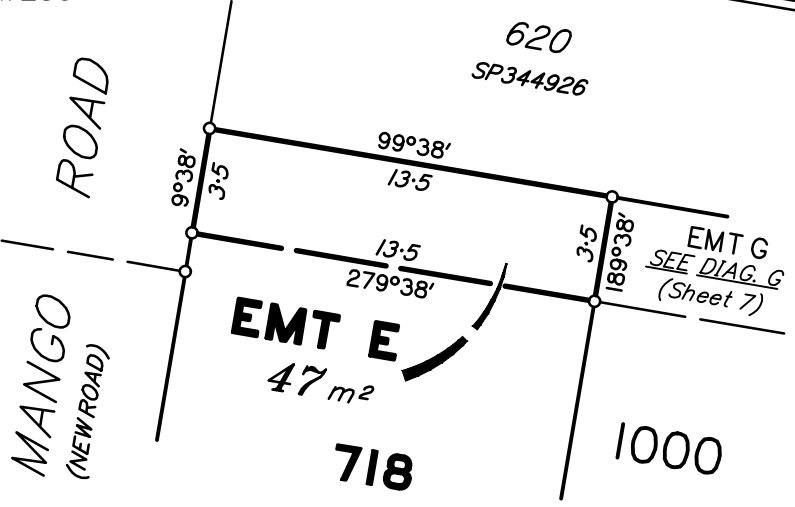

DIAGRAM B  
1:250



PRELIMINARY

ADDITIONAL SHEET

DIAGRAM D  
1:250

Scale 1:250 - Lengths are in metres.

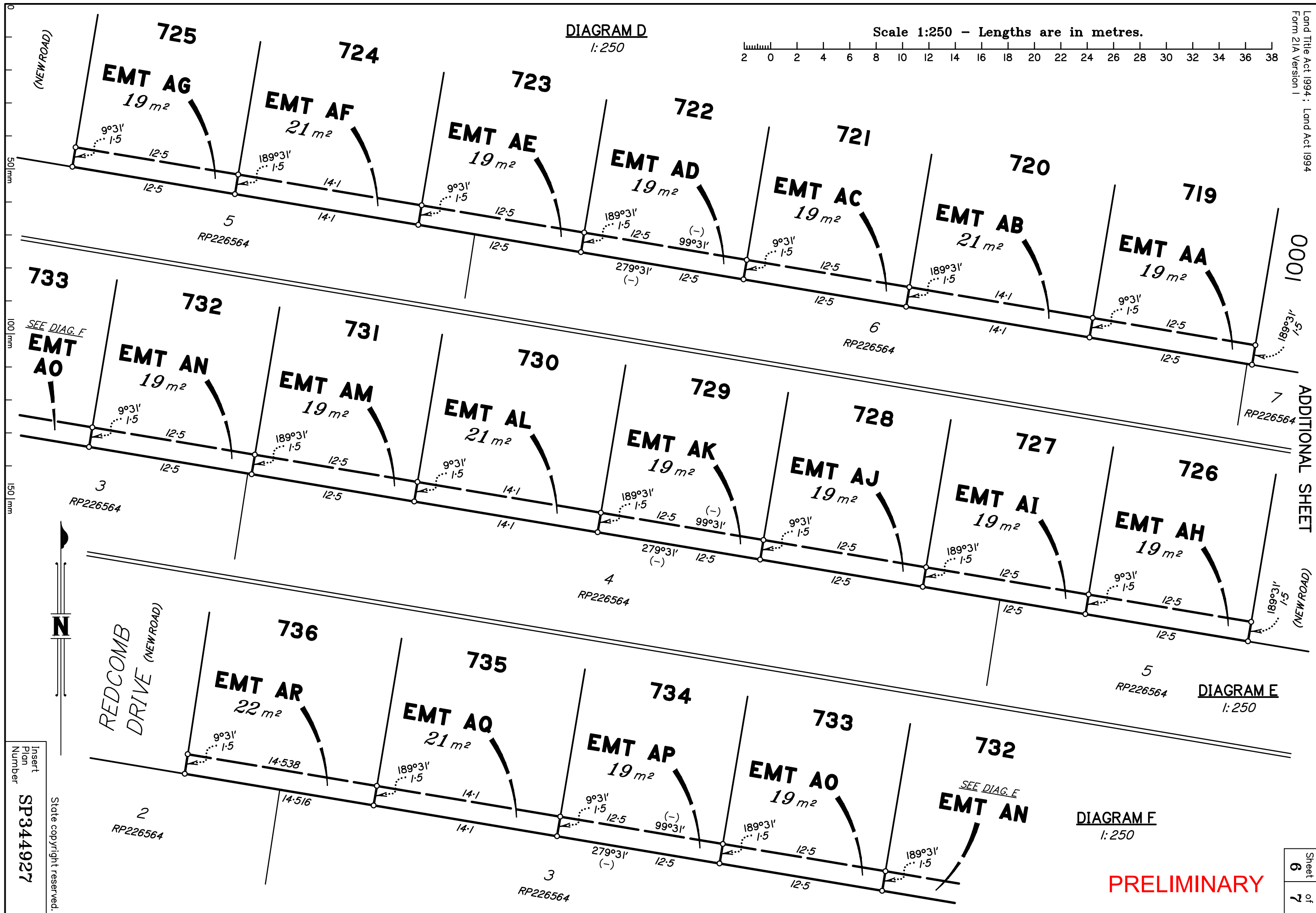
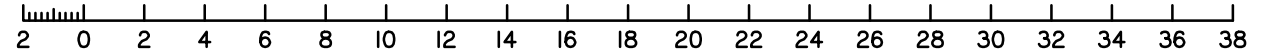

0001

ADDITIONAL SHEET

(NEW ROAD)

DIAGRAM E  
1:250

DIAGRAM F  
1:250

PRELIMINARY

Insert Plan Number  
SP344927  
State copyright reserved.

**DIAGRAM G**  
1:500

M.G.A. COORDINATES GDA-2020 (Adjustment - QLD ANJ 21.04)

STATION	EASTING	NORTHING	ZONE	P.U.	LINEAGE	METHOD	REMARKS

PERMANENT MARKS

PM	ORIGIN	BEARING	DIST	NO	TYPE

REFERENCE MARKS

STN	TO	ORIGIN	BEARING	DIST

REINSTATEMENT REPORT  
.....

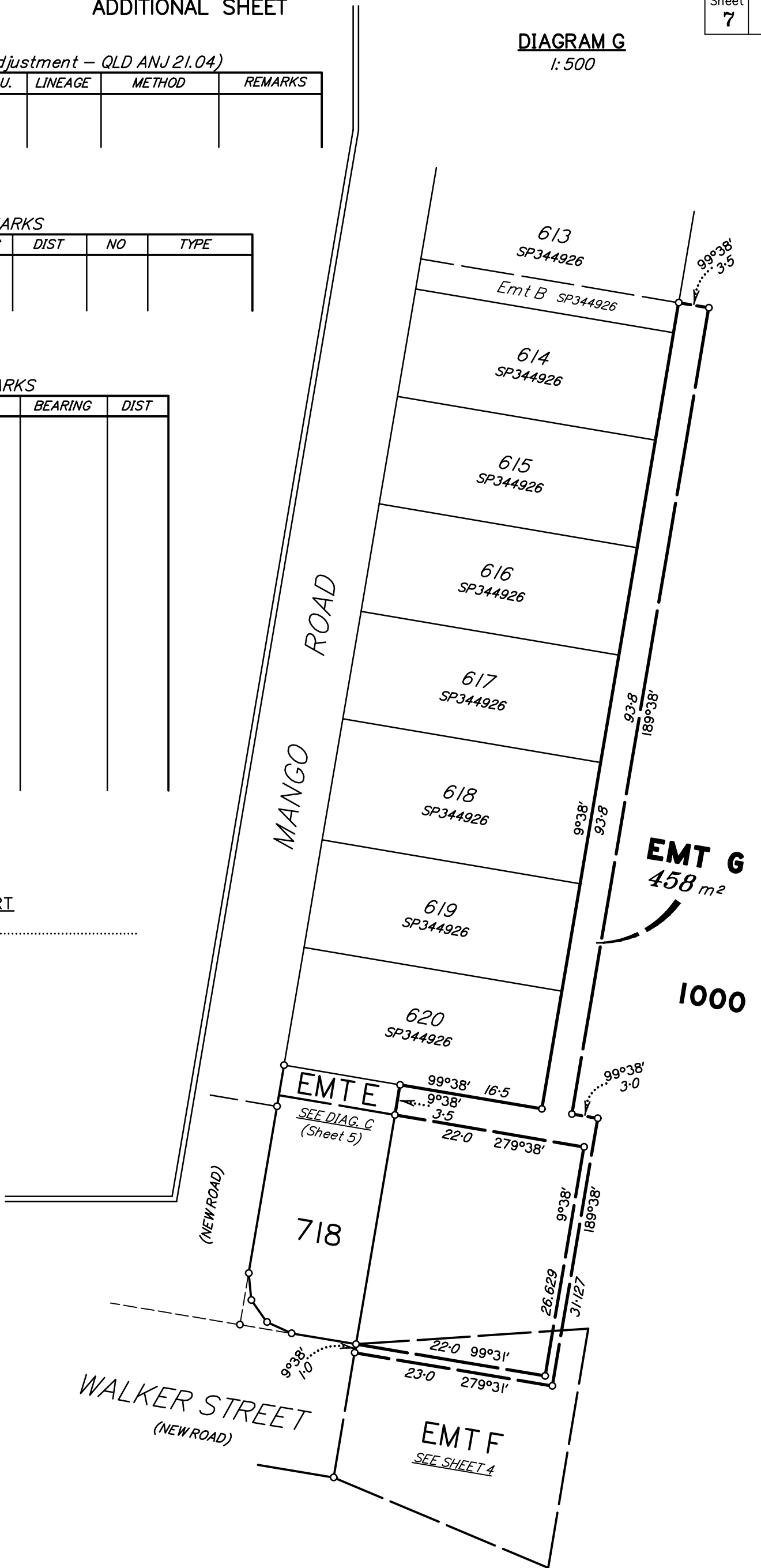

Scale 1:500 - Lengths are in metres.

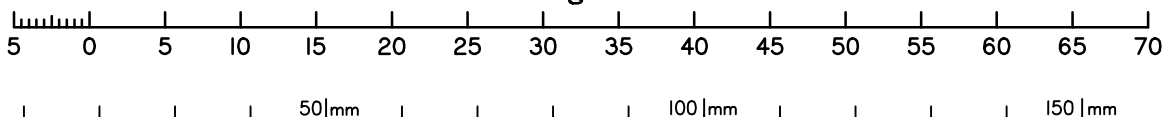

**PRELIMINARY**

State copyright reserved.

Insert Plan Number **SP344927**

## SUMMARY OF NEW EASEMENTS

*Emt F in Lot 1000 is for temporary turnaround benefiting LCC*  
*Emt G in Lot 1000 is for Sewer benefiting LCC*

*Emt P in Lot 704 is for Drainage benefiting Lots 705–710*  
*Emt PA in Lot 704 is for Sewer benefiting LCC*

*Emt Q in Lot 705 is for Sewer benefiting LCC*  
*Emt Q in Lot 705 is for Drainage benefiting Lots 706–710*

*Emt R in Lot 706 is for Sewer benefiting LCC*  
*Emt R in Lot 706 is for Drainage benefiting Lots 707–710*

*Emt S in Lot 707 is for Sewer benefiting LCC*  
*Emt S in Lot 707 is for Drainage benefiting Lots 708–710*

*Emt T in Lot 708 is for Sewer benefiting LCC*  
*Emt T in Lot 708 is for Drainage benefiting Lots 709 & 710*

*Emt U in Lot 709 is for Sewer benefiting LCC*  
*Emt U in Lot 709 is for Drainage benefiting Lot 710*

*Emt V in Lot 710 is for Sewer and Drainage benefiting LCC*

*Emt W in Lot 713 is for Sewer benefiting LCC*  
*Emt W in Lot 713 is for Drainage benefiting Lots 714–717*

*Emt X in Lot 714 is for Sewer benefiting LCC*  
*Emt X in Lot 714 is for Drainage benefiting Lots 715–717*

*Emt Y in Lot 715 is for Drainage benefiting Lots 716 & 717*  
*Emt YA in Lot 715 is for Sewer benefiting LCC*

*Emt Z in Lot 716 is for Sewer benefiting LCC*  
*Emt Z in Lot 716 is for Drainage benefiting Lot 717*

*Emt D in Lot 717 is for Sewer and Drainage benefiting LCC*

*Emt E in Lot 718 is for Sewer benefiting LCC*  
*Emt E in Lot 718 is for drainage benefiting Lot 1000*

*Emt AA in Lot 719 is for drainage benefiting Lot 1000*

*Emt AB in Lot 720 is for drainage benefiting Lots 719 & 1000*

*Emt AC in Lot 721 is for drainage benefiting Lots 719, 720 & 1000*

*Emt AD in Lot 722 is for drainage benefiting Lots 719–721 & 1000*

*Emt AE in Lot 723 is for drainage benefiting Lots 719–722 & 1000*

*Emt AF in Lot 724 is for drainage benefiting Lots 719–723 & 1000*

*Emt AG in Lot 725 is for drainage benefiting Lots 719–724 & 1000*

*Emt AH in Lot 726 is for drainage benefiting LCC*

*Emt AI in Lot 727 is for drainage benefiting Lot 726*

*Emt AJ in Lot 728 is for drainage benefiting Lots 726 & 727*

*Emt AK in Lot 729 is for drainage benefiting Lots 726–728*

*Emt AL in Lot 730 is for drainage benefiting Lots 726–729*

*Emt AM in Lot 731 is for drainage benefiting Lots 726–730*

*Emt AN in Lot 732 is for drainage benefiting Lots 726–731*

*Emt AO in Lot 733 is for drainage benefiting Lots 726–732*

*Emt AP in Lot 734 is for drainage benefiting Lots 726–733*

*Emt AQ in Lot 735 is for drainage benefiting Lots 726–734*

*Emt AR in Lot 736 is for drainage benefiting Lots 726–735*